

ZONING PERMIT

Town of Pomfret, Vermont
ZONING PERMIT APPLICATION

Permit No.

ZP20~~21~~ 24-04

0 1 0 B - []

Parcel ID number

\$ 150000

Est. cost of project

[]

App. fee**

Applicant Joseph & Cara Defoor

[] [] [] - [] [] [] - [] [] []

Phone Number (daytime)

Address P.O. Box 219

South Pomfret, VT 05067

Lot Size: _____

Email joedefoor@gmail.com

Street Address of Property 1799 Pomfret Road South Pomfret, VT 05067

Property Owner (if not same as Applicant) _____

Address _____

DESCRIPTION OF PROPOSED WORK

Description of proposed work (incl. dimensions): Proposed bridge intended to accommodate heavier and larger vehicles, refer to site plan.

Closest distance between new structure/addition and the following property lines (as shown on sketch):

front/street: 435 +/- ft. back: 1090 +/- ft. right: 332 +/- ft. left: 400 +/- ft.

Height: N/A ft. No. & type of farm animals for farm structures: N/A

NOTICE: Permits must be approved a minimum of 15 days before commencing new use or construction. Use or construction authorized by this permit must be commenced within one year of issue unless delayed by ligation or permit expires.

ACTION OF THE ADMINISTRATIVE OFFICER

ID of zoning district: Rural ID and classification of use: Flood Hazard Area

Application is REFERRED to the ZBA or PC for the following review and approval:

Ridgeline Variance Conditional Use Other: _____

0 3 - 0 5 - 2 0 AO Signature: Karen Hewitt Osnoe

FINAL ACTION OF THE ADMINISTRATIVE OFFICER

APPROVED APPROVED with conditions noted DENIED NO PERMIT REQUIRED

Comments: _____

[] [] - [] [] - 2 0 AO Signature: _____

WARNING: State permits may be required for this project. Call 802-279-4747 to speak to the State Permit Specialist before beginning construction.

**See current fee schedule. Make check payable to Town of Pomfret.

PROPERTY SKETCH

ZP20-

INSTRUCTIONS: Draw a lot outline and proposed construction within the lot showing distances to boundaries, existing buildings and location of roads, drives and parking. Show septic facilities and water supply for new residences. Indicate North on your sketch. Use another sheet or attach plans if appropriate.

See attached site plan

CERTIFICATIONS OF APPLICANT AND/OR PROPERTY OWNER

PROPERTY OWNER: The undersigned property owner hereby certifies that the information on this application is true and accurate, consents to its submission, and understands that if the application is approved, the zoning permit and any attached conditions will be binding on the property. Further, the undersigned authorizes the Administrative Officer access, at reasonable times, to the property covered by the permit issued under this application, for the purposes of ascertaining compliance with said permit.

Property Owner's signature

Date

APPLICANT (if not property owner): The undersigned applicant hereby certifies that ALL the information submitted on and with this application is true and accurate.

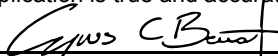

Applicant's signature

4/17/23

Date

OFFICE USE ONLY

- -

Received

\$ - -

Fee Paid or deposited

- -

Application deemed complete

An applicant and/or interested person (as defined in 24 VSA §4464) may appeal any decision of the Administrative Officer to the Zoning Board of Adjustment (ZBA) within 15 days of the date of the decision. Said notice shall be in writing, mailed or delivered to the Clerk of the ZBA, and give the reasons for the appeal. Failure to appeal this decision may prevent any party from arguing against its elements in a future hearing or appeal. 24 VSA §4472.

**AUTHORIZATION TO CONDUCT
STREAM ALTERATION ACTIVITIES**

Pursuant to Section C.2.2, and C.2.3
of the Vermont Stream Alteration General Permit

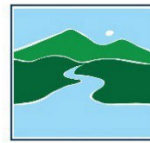

VERMONT DEPARTMENT OF
ENVIRONMENTAL CONSERVATION

**WATERSHED
MANAGEMENT DIVISION**

RIVERS PROGRAM

(Reporting activities requiring Application or Registration)

A. Permitted Project Information:

Permit Number: SR-3706	Waterbody: Barnard Brook
Project Location: 1799 Pomfret Rd	Lat:/Long: 43.66128N, 72.53669W
Applicant Name: Joseph and Cara Defoor	Email: joedefoor@gmail.com
Mailing Address: PO Box 219, South Pomfret, VT 05067	Phone: (404) 735-5481

B. Findings:

The Secretary of the Vermont Agency of Natural Resources (VT ANR) has determined that:

This project consists of the construction of a new bridge to access an existing house.

1. The proposed activity is eligible for coverage under the Vermont ANR Stream Alteration General Permit.
2. The proposed activity will meet the terms and conditions of the General Permit provided:
 - a) The project will be completed as in the plans by Harrington Civil Engineering dated February 05, 2023.

C. Standard Conditions:

1. The project will not adversely affect the public safety by increasing flood hazards.
2. The project will not significantly damage fish life or wildlife.
3. The project will not significantly damage the rights of riparian owners.
4. The project will not obstruct the movement of aquatic life indigenous to the waterbody beyond the actual duration of construction.
5. The project is conducted in a manner which minimizes or avoids any discharge of sediment or other pollutants to surface waters in violation of the Vermont Water Quality Standards.
6. **An on-site preconstruction meeting is conducted with the contractor and RME prior to the start of instream work.**
7. The River Management Engineer is notified by phone or email when construction begins and when the project is complete.
8. **In-stream working dates for all GP activities are from June 1st through October 1st; any in-stream work outside these dates will require consultation with and prior authorization from the River Management Engineer (RME).**
9. **This permit will expire: December 31, 2028**

If there are any changes in the project plan or deviation in construction from the approved plan, the Permittee must notify the River Management Engineer immediately. If the project is constructed as you have described, as shown on the above referenced approved plans and per the above conditions, there is no reason to expect any violation of Vermont Water Quality Standards.

Please be aware that the proposed project is in a municipality that participates in the National Flood Insurance Program (NFIP).

Construction or storage within the Special Flood Hazard Area (SFHA) as delineated on the FEMA Flood Insurance Rate Map.

24 VSA, Section 4424 requires communities to submit SFHA permit applications to the ANR Regional Floodplain Manager for review and comment to ensure the project is compliant with local and NFIP minimum floodplain management standards.

Please be aware that this authorization does not constitute ANR's review and comment under 24 VSA Section 4424.

D. Authorization:

Signed this 27th day of March 2024
Julia S. Moore, Secretary, Vermont Agency of Natural Resources

by:  River Management Engineer
VT DEC Rivers Program, Watershed Management Division

E. River Engineer Contact Information

Engineer: **Scott Jensen, PE**

Contact Phone: **802 490-6962**

Email Address: scott.jensen@vermont.gov

State of Vermont – ANR Department of Environmental Conservation
Watershed Management Division - Stream Alteration Permitting
1 National Life Drive, Main 2 Montpelier, VT 05620-3522

SITE PLAN
SCALE: 1"=30'

GRAPHIC SCALE

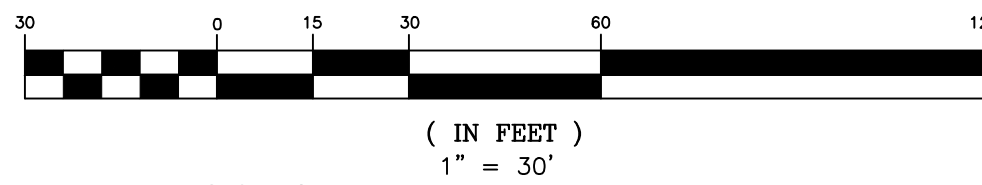

LEGEND

- EXISTING**
- PL+/- APPROXIMATE PROPERTY LINE
 - 720 EXISTING MAJOR 10' CONTOUR (LIDAR)
 - 716 EXISTING MINOR 1' CONTOUR (LIDAR)
 - CENTERLINE BROOK
 - OHE OVERHEAD ELECTRICAL LINE
 - FENCE
 - BUILDING
 - BENCHMARK
 - △ SURVEY TRAVERSE POINT
 - APPROXIMATE TREE LINE
 - ☉ TREE, AS NOTED
 - BFE CALCULATED BASE FLOOD ELEVATION LIMIT
 - FEMA ZONE A LINE - APPROXIMATE
- PROPOSED**
- ☉ UTILITY POLE
 - 715 FINAL CONTOUR
 - DRIVEWAY
 - BRIDGE
 - STONE FILL AS PER VTRANS TYPE IV SEE DETAIL SHEET 2
 - TREE LINE

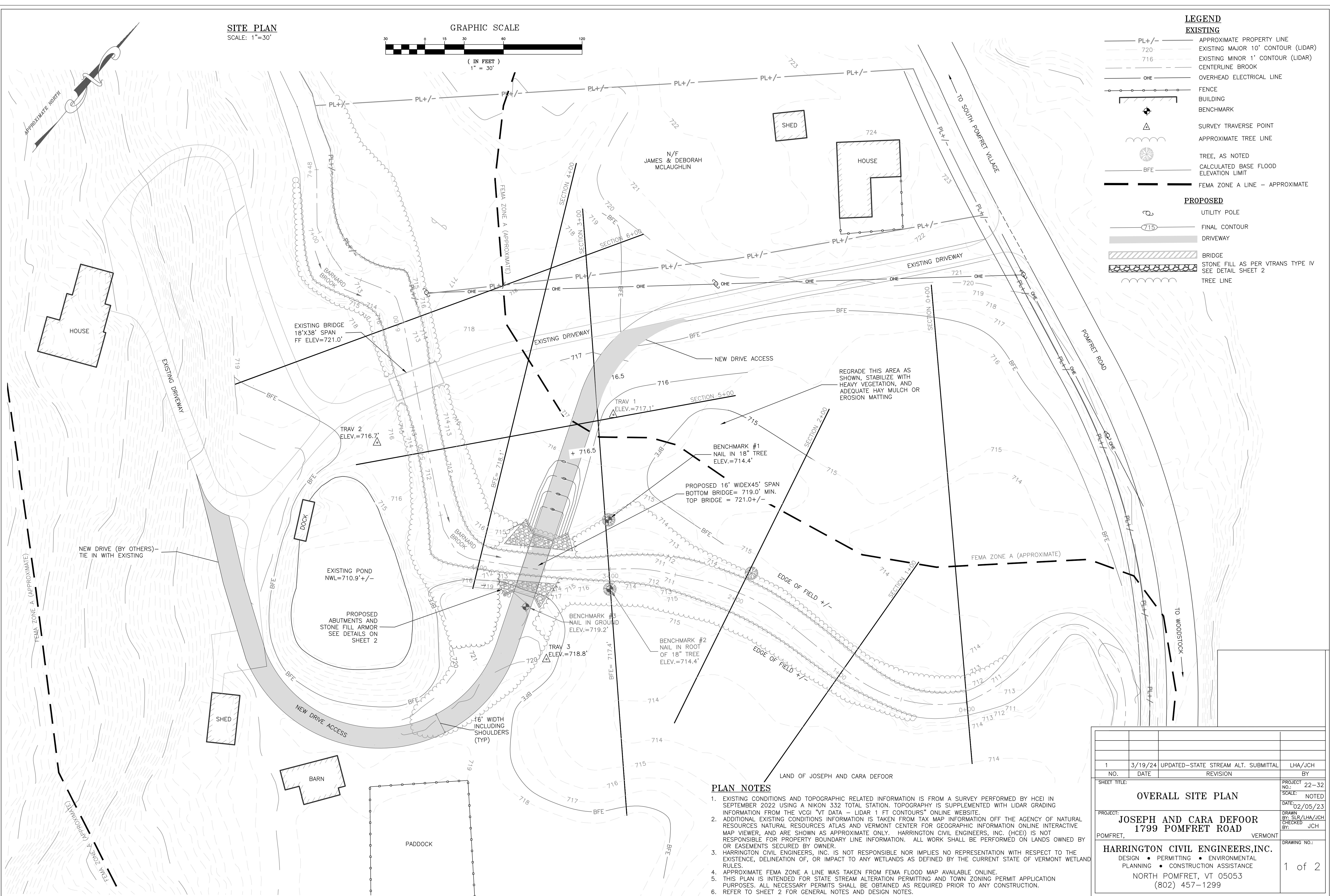

PLAN NOTES

1. EXISTING CONDITIONS AND TOPOGRAPHIC RELATED INFORMATION IS FROM A SURVEY PERFORMED BY HCEI IN SEPTEMBER 2022 USING A NIKON 332 TOTAL STATION. TOPOGRAPHY IS SUPPLEMENTED WITH LIDAR GRADING INFORMATION FROM THE VCGI "VT DATA - LIDAR 1 FT CONTOURS" ONLINE WEBSITE.
2. ADDITIONAL EXISTING CONDITIONS INFORMATION IS TAKEN FROM TAX MAP INFORMATION OFF THE AGENCY OF NATURAL RESOURCES NATURAL RESOURCES ATLAS AND VERMONT CENTER FOR GEOGRAPHIC INFORMATION ONLINE INTERACTIVE MAP VIEWER, AND ARE SHOWN AS APPROXIMATE ONLY. HARRINGTON CIVIL ENGINEERS, INC. (HCEI) IS NOT RESPONSIBLE FOR PROPERTY BOUNDARY LINE INFORMATION. ALL WORK SHALL BE PERFORMED ON LANDS OWNED BY OR EASEMENTS SECURED BY OWNER.
3. HARRINGTON CIVIL ENGINEERS, INC. IS NOT RESPONSIBLE NOR IMPLIES NO REPRESENTATION WITH RESPECT TO THE EXISTENCE, DELINEATION OF, OR IMPACT TO ANY WETLANDS AS DEFINED BY THE CURRENT STATE OF VERMONT WETLAND RULES.
4. APPROXIMATE FEMA ZONE A LINE WAS TAKEN FROM FEMA FLOOD MAP AVAILABLE ONLINE.
5. THIS PLAN IS INTENDED FOR STATE STREAM ALTERATION PERMITTING AND TOWN ZONING PERMIT APPLICATION PURPOSES. ALL NECESSARY PERMITS SHALL BE OBTAINED AS REQUIRED PRIOR TO ANY CONSTRUCTION.
6. REFER TO SHEET 2 FOR GENERAL NOTES AND DESIGN NOTES.

NO.	DATE	REVISION	BY
1	3/19/24	UPDATED-STATE STREAM ALT. SUBMITTAL	LHA/JCH
SHEET TITLE: OVERALL SITE PLAN			
PROJECT: JOSEPH AND CARA DEFOOR 1799 POMFRET ROAD			
DRAWN BY: SLR/LHA/JCH CHECKED BY: JCH			
DRAWING NO.: 1 of 2			

SECTION A-A BRIDGE APPROACH AND BRIDGE PROFILE

SCALE: 1"=5'(H+V)

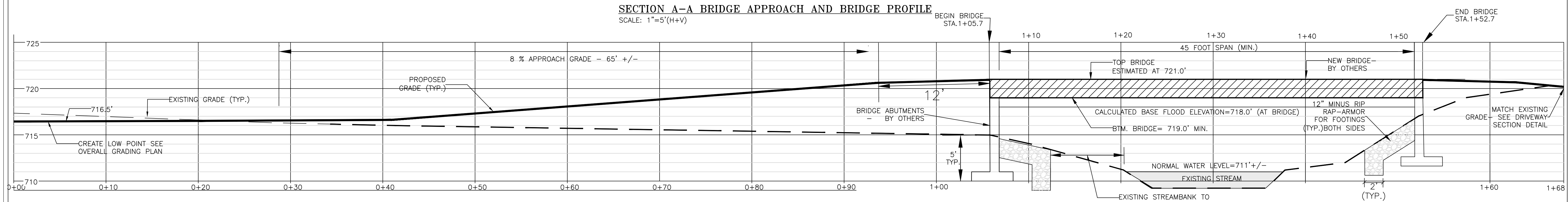

BRIDGE ABUTMENT PLAN

SCALE: 1"=10'

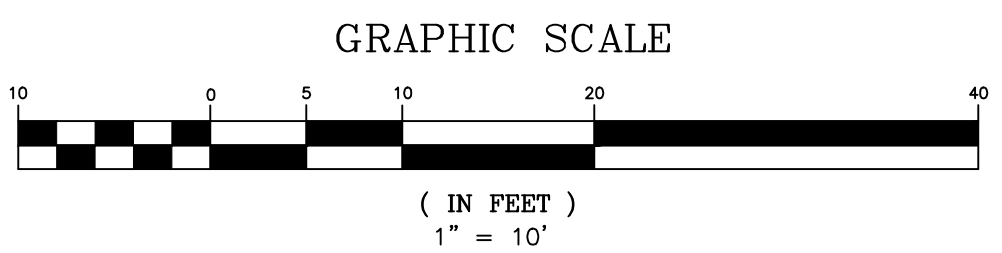
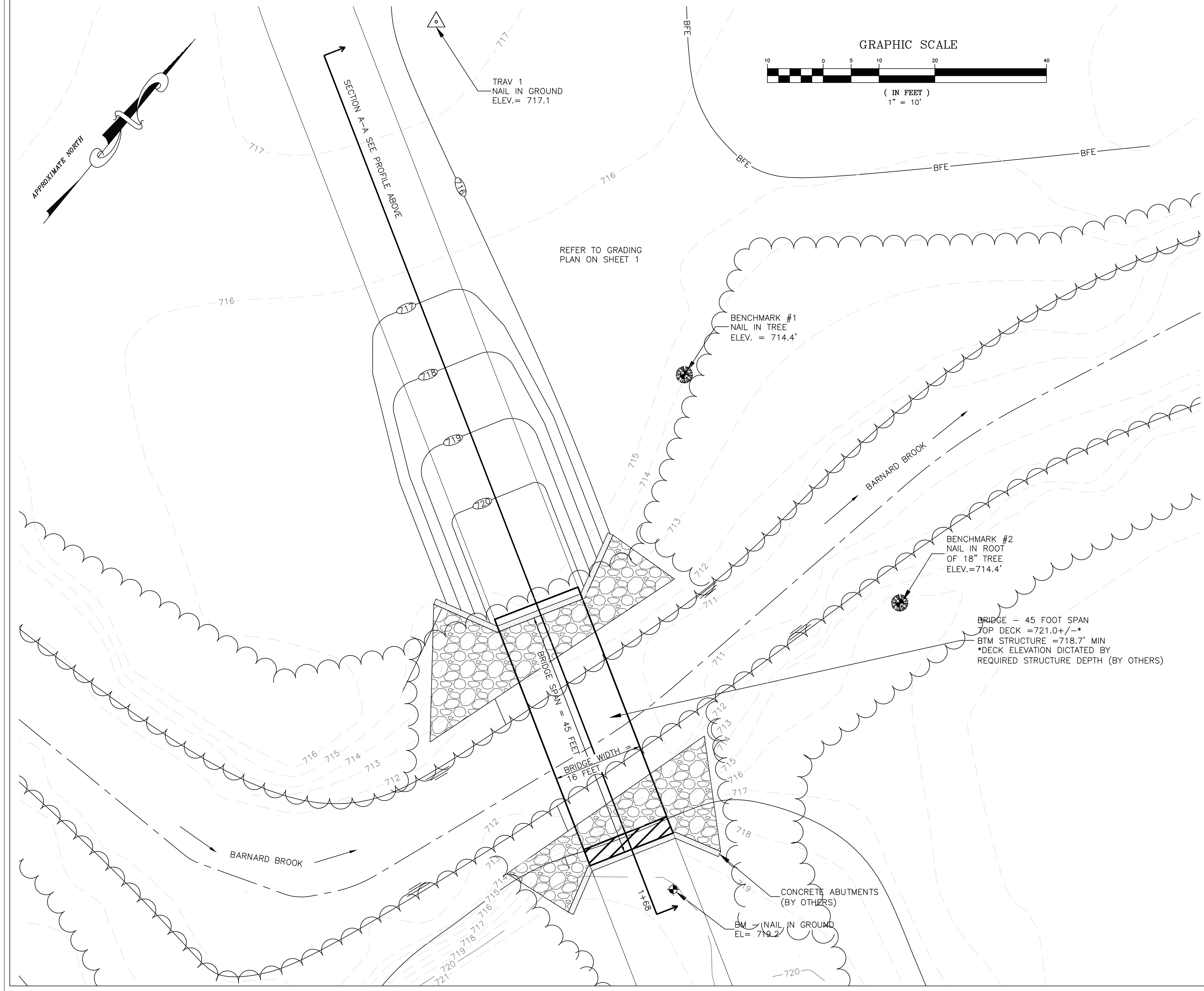

GENERAL NOTES

1. CONTRACTOR TO REPORT ALL ERRORS AND OMISSIONS TO DESIGNER IMMEDIATELY.
2. CONTRACTOR IS WARNED THAT UNDERGROUND UTILITIES MAY BE PRESENT THAT ARE NOT SHOWN ON THESE PLANS AND IS ADVISED TO CALL DIG-SAFE PRIOR TO CONSTRUCTION.
3. CONTRACTOR IS RESPONSIBLE FOR ALL NECESSARY EROSION CONTROL MEASURES.

DESIGN NOTES

1. BASE FLOOD ELEVATION WAS CALCULATED USING THE US ARMY CORPS OF ENGINEERS HEC RAS® COMPUTER PROGRAM. CROSS SECTIONS WERE DEVELOPED FROM HCEI SURVEY AND LIDAR CONTOUR INFORMATION, REFERENCED ON SHEET 1. DESIGN FLOW ASSUMED IS 2330 CFS (CUBIC FEET PER SECOND) AND WAS TAKEN FROM USGS STREAM STATS FLOW REGRESSION INFORMATION FOR THE 1% (100 YEAR) STORM EVENT.
2. FLOW EQUILIBRIUM IS DEMONSTRATED THROUGH SEPARATE HEC RAS CALCULATIONS. THE CALCULATED TOTAL VELOCITY AT STATION 0+00 IS 5.75 FT/SEC FOR PRE AND POST CONDITIONS, AND CALCULATED WATER SURFACE ELEVATION IS THE SAME.
3. THE GRADING SHOWN ON THIS PLAN IS DESIGNED TO BE AT LEAST NET ZERO FLOOD VOLUMES, THE CALCULATED FILL AMOUNT IN THE FLOOD PLAIN DUE TO BRIDGE APPROACHES IS 170 CUBIC YARDS, AND TOTAL CALCULATED CUT AMOUNT IN THE FLOOD PLAIN IS 195 CUBIC YARDS FOR AN ESTIMATED FLOOD STORAGE VOLUME OF -25 CUBIC YARDS.
4. THIS DESIGN IS INTENDED FOR BASE FLOOD LIMIT AND GRADING PURPOSES ONLY. THIS DESIGN DOES NOT INCLUDE A STRUCTURAL DESIGN FOR THE BRIDGE OR ABUTMENTS/WINGWALLS.

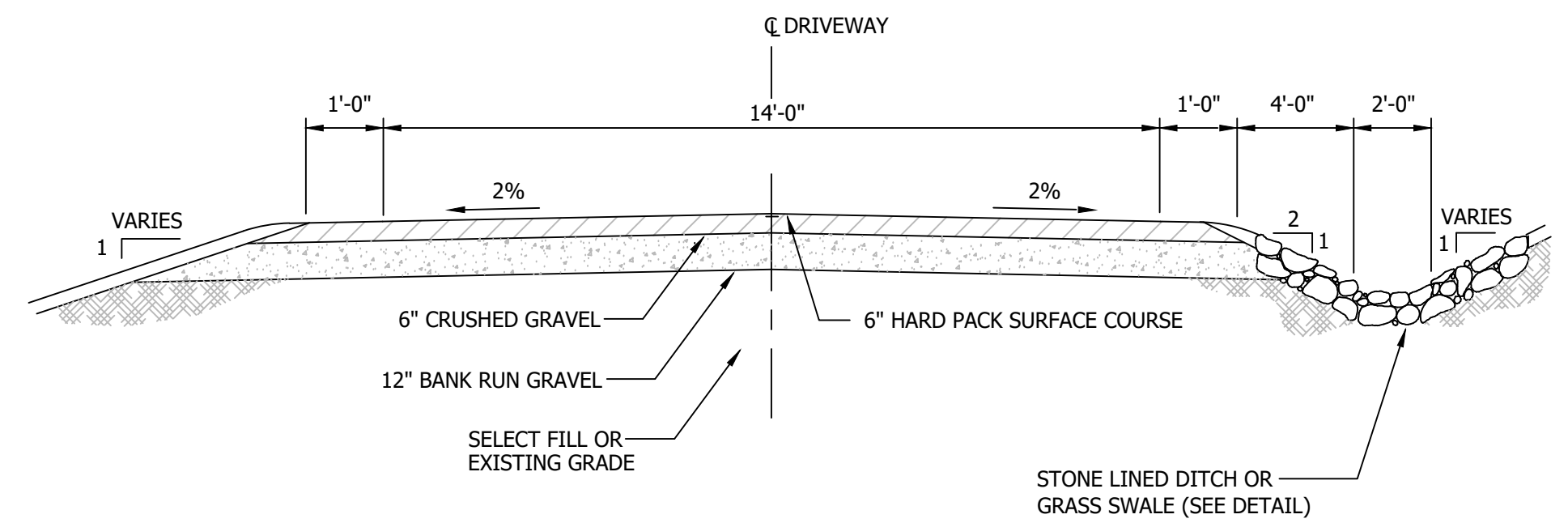

TYPICAL DRIVEWAY CROSS SECTION

NOT TO SCALE

LEGEND

- EXISTING**
- 720 EXISTING MAJOR CONTOUR (LIDAR)
 - 716 EXISTING MINOR 1' CONTOUR (LIDAR)
 - CENTERLINE BROOK
 - OHE OVERHEAD ELECTRICAL LINE
 - FENCE
 - ⊕ BENCHMARK
 - △ SURVEY TRAVERSE POINT
 - ⊗ TREE, AS NOTED
 - EXISTING TREE LINE
 - BFE BASE FLOOD ELEVATION
 - FEMA ZONE A LINE
- PROPOSED**
- 715 FINAL CONTOUR
 - DRIVEWAY
 - ▨ BRIDGE
 - STONE FILL AS PER VTRANS TYPE IV SEE DETAIL SHEET 2
 - TREELINE

NO.	DATE	REVISION	BY
1	3/19/24	UPDATED-STATE STREAM ALT. SUBMITTAL	LHA/JCH
SHEET TITLE:			
BRIDGE APPROACH AND ABUTMENT PLAN, PROFILE, DETAILS, AND NOTES			PROJECT NO.: 22-32
PROJECT: JOSEPH AND CARA DEFOOR 1799 POMFRET ROAD			SCALE: NOTED
POMFRET, VERMONT			DATE: 02/05/23
HARRINGTON CIVIL ENGINEERS, INC.			DRAWN BY: SLR/LHA/JCH
DESIGN • PERMITTING • ENVIRONMENTAL PLANNING • CONSTRUCTION ASSISTANCE			CHECKED BY: JCH
NORTH POMFRET, VT 05053 (802) 457-1299			DRAWING NO.: 2 of 2